

Ø 45 x 80 mm

- Reserve-toilet roll holder in solid, germ-reducing and easy-care stainless steel (AISI 303), satin finished. Further available surfaces: see below.
- Designed for one standard toilet roll with dimensions:
 - Outer diameter max. 125 mm
 - Width max. 100 mm
 - Core diameter min. 38 mm
- Concealed, centric, anti-theft wall disc mounting.
- Holder diameter 16 mm, length 80 mm.
- Mounting with one screw.
- Delivery includes fixing material.
- Weight, including single package: 0.2 kg



Suggested text for specifications:

Reserve-toilet roll holder in solid stainless steel (AISI 303), satin finished, for surface mounting. Concealed, centric, anti-theft wall disc mounting. Delivery includes fixing material.

Dimensions: Ø 45 x 80 mm

Article No. AC222

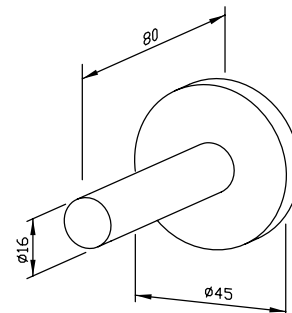

Available surfaces	ID No.
satin finished (standard)	700 222
highly polished	731 222