

Technical information for hinges

Hinges

In the tables on the following pages are listed a large range of hinge variations. Many more variations are possible if hinges with guide tabs are required i.e. when combining aluminium profiles with different slot widths.

Left and right hinge

Each lift-off hinge has a left and right version, before ordering it should be known on which side the door or hatch is to be mounted.

Left hinge.

The left hinge half is fixed.
The hatch or door opens from right to left.

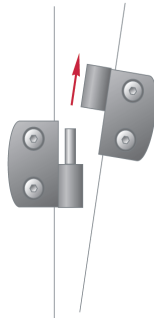

Right hinge.

The right hinge half is fixed.
The hatch or door opens from left to right.

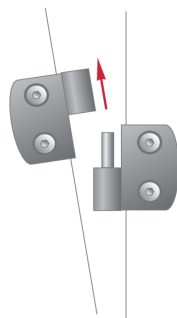

Fixed hinge.

The hinge is non-liftoff.
It is suitable for opening left or right.

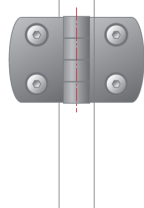

Guide tabs

Many hinges can be supplied on request with guide tabs for the slots of aluminium profiles. They secure the hinge against twisting and make it stronger. The hinges are designed in such a way that the guide tabs can simply be broken out with a screwdriver.

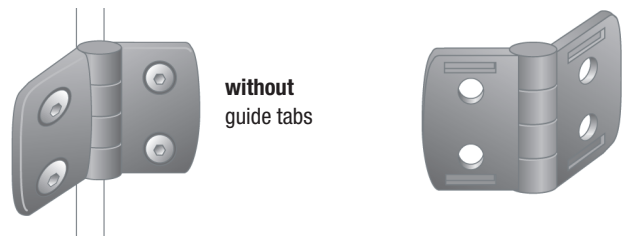

without
guide tabs

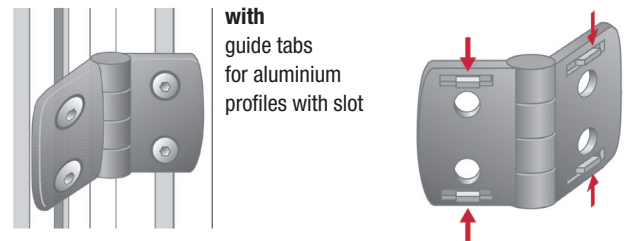

with
guide tabs
for aluminium
profiles with slot

Tip

If you want to fit a door or hatch so that it cannot be lifted off, you can still use a left and right lift-off hinge. The two hinges are fitted in the end position and secure each other mutually.

